

INDICE PRODOTTI - PRODUCT CONTENTS

pag. 40-45

SPECIFICHE TECNICHE
TECHNICAL SPECIFICATIONS

pag. 46-47

PRESCRIZIONI DI UTILIZZO
USE INSTRUCTIONS

pag. 48-53

ESEMPI E APPLICAZIONI
EXAMPLES AND APPLICATIONS

pag. 54-57

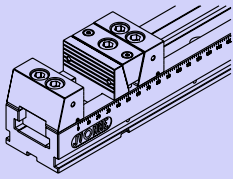

MORSA MULTIPRESA 80
MULTI-GRIP VICE 80

pag. 58-61

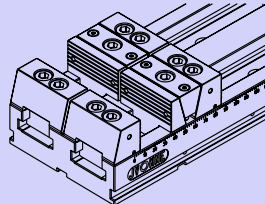

MORSA MULTIPRESA 160
MULTI-GRIP VICE 160

pag. 62-65

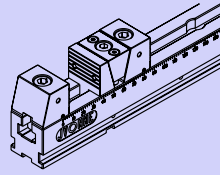

MORSA MULTIPRESA 50
MULTI-GRIP VICE 50

pag. 66-69

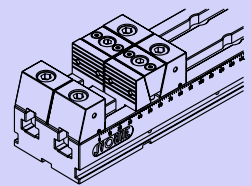

MORSA MULTIPRESA 100
MULTI-GRIP VICE 100

pag. 70-71

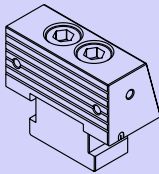

RICAMBI MORSE MULTIPRESA
80-160
MULTI-GRIP VICE 80-160
SPARE PARTS

pag. 72

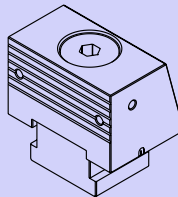

COMPONENTI MORSE
MULTIPRESA 80-160
FORTE SERRAGGIO
MULTI-GRIP VICE 80-160 PARTS
INTENSE TIGHTENING

pag. 73

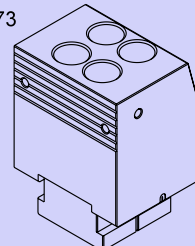

COMPONENTI MORSE
MULTIPRESA 80-160
PRESA ALTA
MULTI-GRIP VICE 80-160 PARTS
HIGH GRIP

pag. 74-75

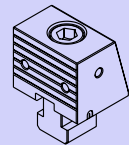

RICAMBI MORSE MULTIPRESA
50-100
MULTI-GRIP VICE 50-100
SPARE PARTS

MORSE MULTIPRESA - MULTI-GRIP VICES

MORSE MULTIPRESA
MULTI-GRIP VICES

1



Materiale: 18 NiCrMo5 UNI EN 10083 ricavato da tondo
Material: 18 NiCrMo5 UNI EN 10083 obtained from rod

2

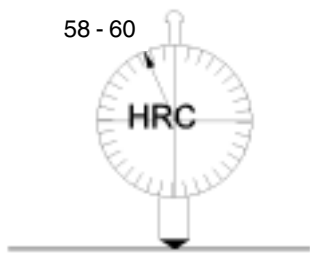

58 - 60
HRC

Durezza superficiale dopo cementazione e tempra
Surface hardness after casehardening and tempering

3

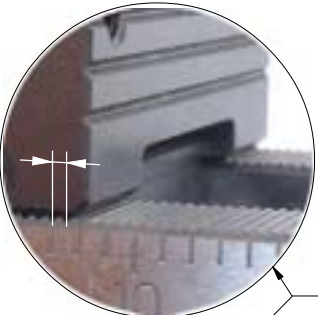

1,5 mm x 90° +/- 0,02

Passo della dentatura rettificata
Pitch of ground toothing

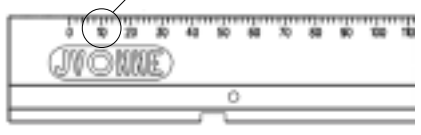

4



Scala graduata incisa su temperato dopo rettifica
Graduated scale cut on hardened workpiece following grinding

5

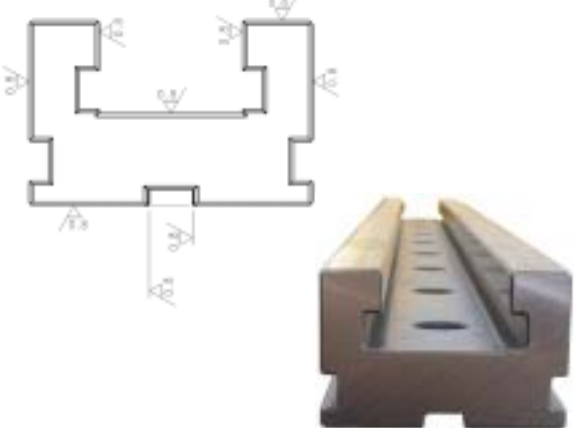

Misure del profilo tutte rettificate +/- 0,02 mm
Measurements of section, all ground +/- 0.02mm

6



Doppia vite M12 (12.9) per maggior efficacia di reazione
Double screw M12 (12.9) for improved reaction effectiveness

MORSE MULTIPRESA - MULTI-GRIP VICES

7 TIPO "A"



TIPO "B"



Gruppo di spinta molto compatto e rigido
Very compact and rigid thrust unit

8

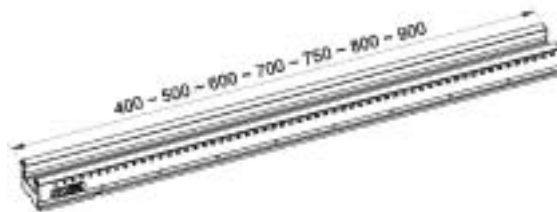

Lunghezza morsa fino a 900 mm
Vice length up to 900 mm

9

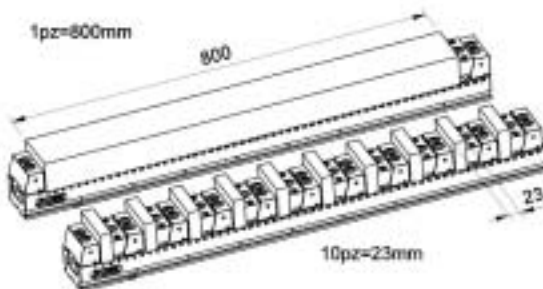

Con la stessa morsa
With the same vice

10

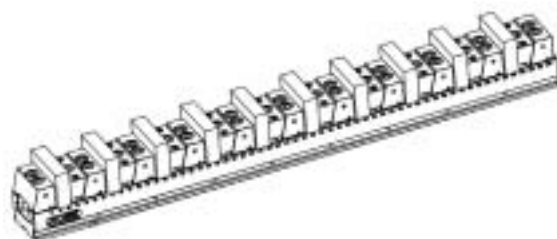

Massimo rapporto ingombro/pezzo
Maximum overall size/piece ratio

11

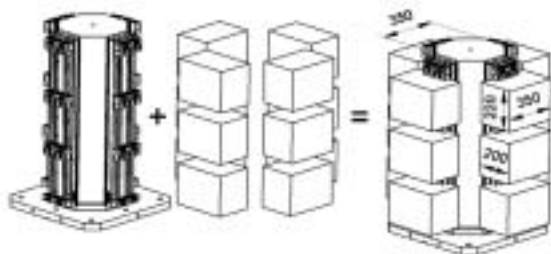

Peso Cubo
Cube weight
450 Kg

Peso pz. 950 Kg Acciaio
Weight of pc: 950 kg Steel
Peso pz. 550 Kg Alluminio
Weight of pc: 550 kg aluminium

Massimo peso caricabile
Maximum loadable weight

12

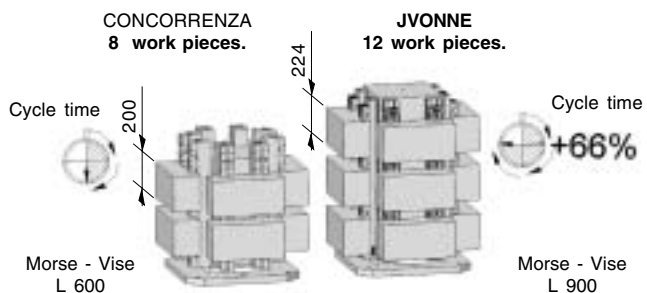

MORSE MULTIPRESA - MULTI-GRIP VICES

13

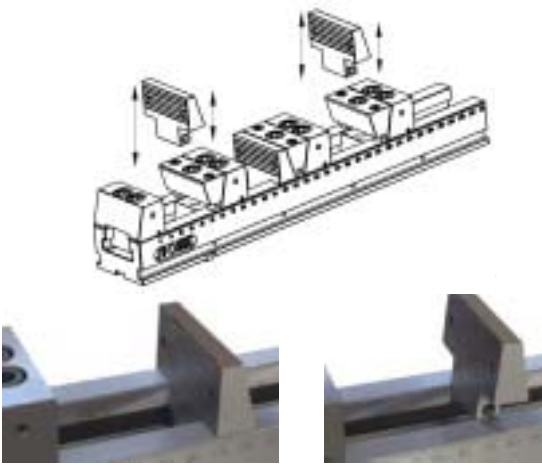

Estrazione rapida della ganaschia mobile
Rapid extraction of movable jaw

14



ISO 9000 - Cert. n° 1194/0

Azienda con sistema di qualità certificato
Company with certified Quality Assurance system

15

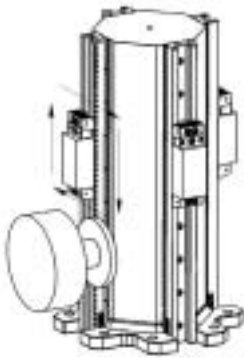

In tutte le morse multipresa JVONNE lo Zero pezzo NON è
vicolato a inizio morsa
In all JVONNE vices, the zero position of the workpiece is NOT
locked at the beginning of the vice

16



Made in Italy

Progettate e costruite interamente in Italia
100% made and designed in Italy



17

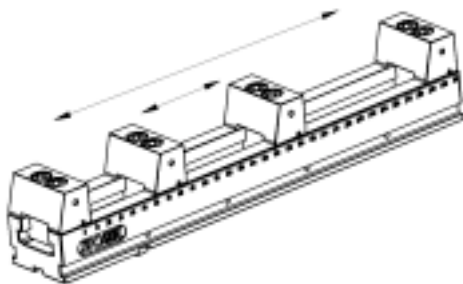

La ganaschia fissa di riferimento per lo Zero pezzo si può
posizionare a piacere sulla dentatura
The fixed reference jaw for the zero position of the workpiece
can be positioned wherever you prefer on the toothing

18



Con il Cubo multipresa ottagonale Plus, possibilità di utilizzare
al massimo tutta la corsa utile del mandrino
With the orthogonal multi-grip cube PLUS, you can fully exploit
the whole useful stroke of the spindle.

MORSE MULTIPRESA - MULTI-GRIP VICES

19

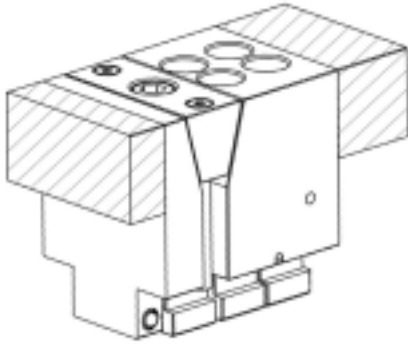

Personalizzazione della presa pezzo con ganasce lavorabili o temperate
The workpiece gripper can be customised with machinable or hardened jaws

20



Studio soluzioni personalizzate con Work Station 3D CATIA
Personal solutions with Work Station 3D CATIA

21

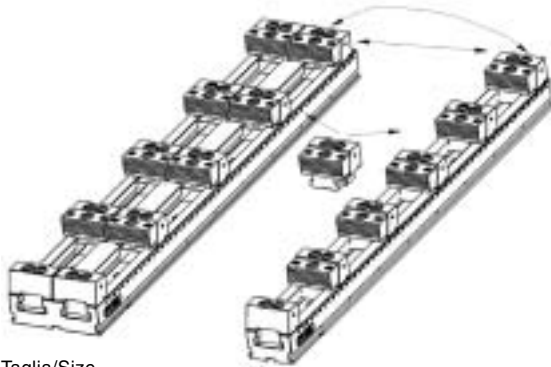

Taglia/Size
160

Taglia/Size
80

Intercambiabilità di tutti i componenti
All components are interchangeable

22

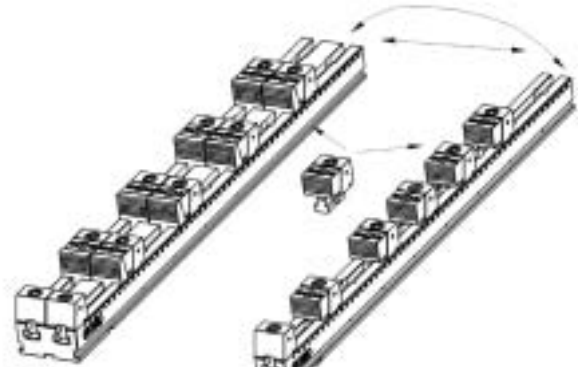

Taglia/Size
100

Taglia/Size
50

Intercambiabilità di tutti i componenti
All components are interchangeable

23

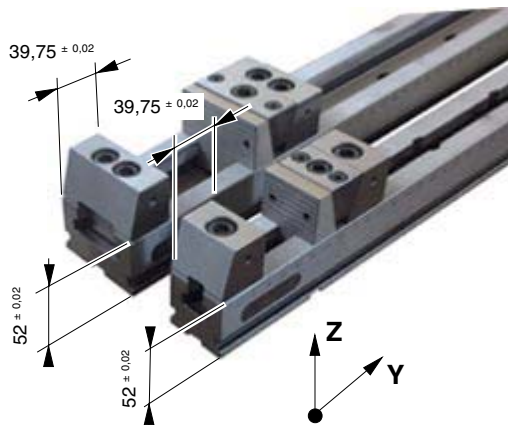

Stesso "0" pezzo in Z e Y per taglie 50-80-100-160
Same "0" position of workpiece in Z and Y for size 50-80-100-160

24

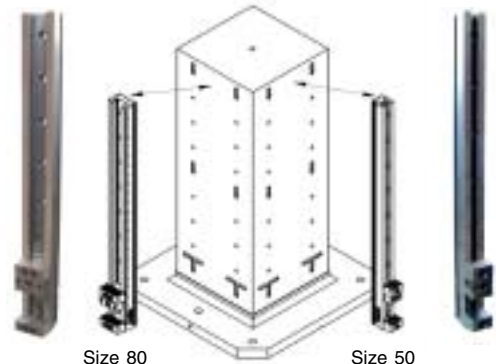

Size 80

Size 50

Intercambiabilità delle sedi per le taglie 50 - 80 - 100 - 160
The seats are interchangeable for sizes 50 - 80 - 100 - 160

SCHEMA DI FUNZIONAMENTO

OPERATING LAYOUT

TIPO "A"

(traslante) (sliding)

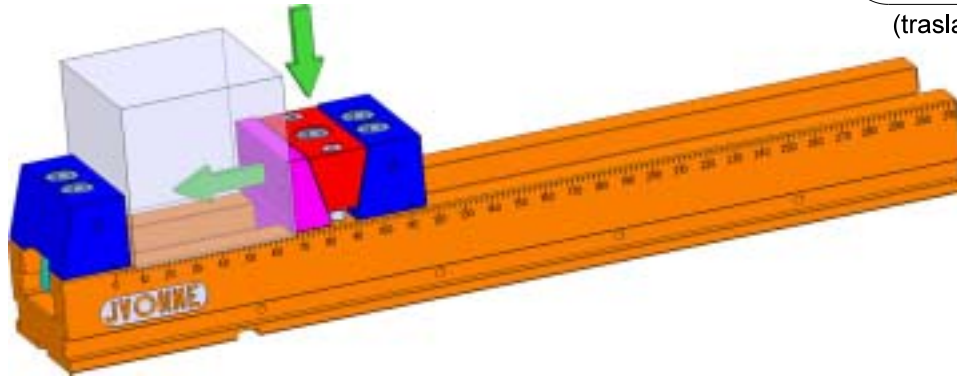

TIPO "B"

(discendente) (descending)

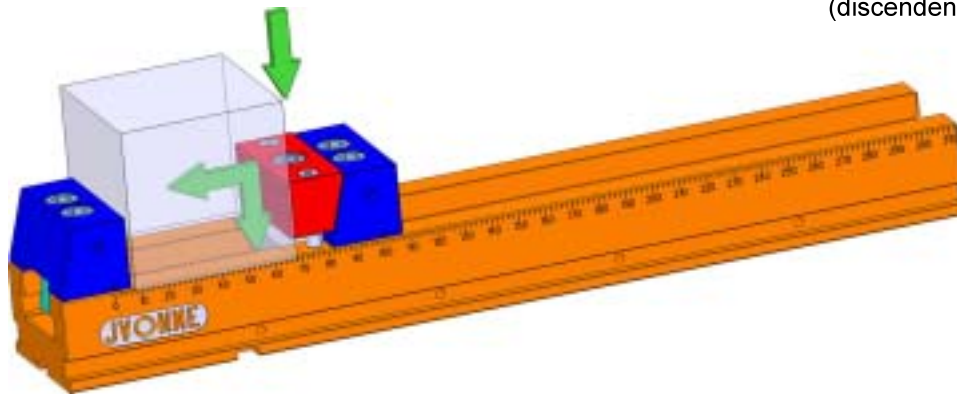

TIPO "C"

(2x1)
(traslante) (sliding)

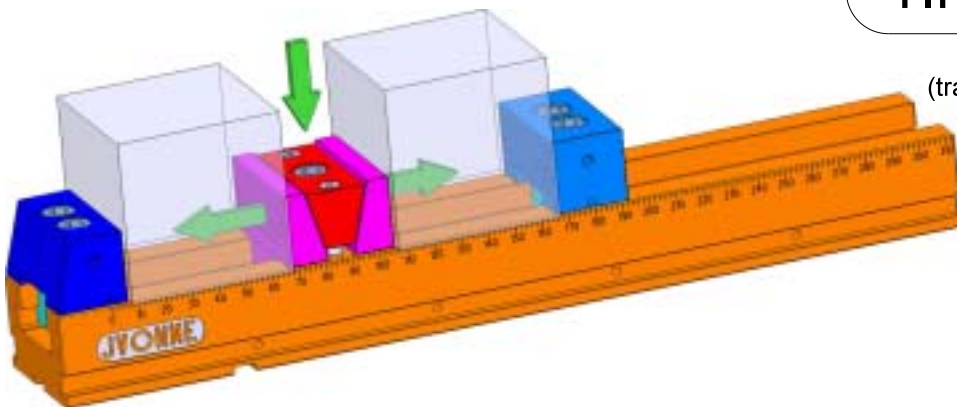

MORSE MULTIPRESA

MULTI-GRIP VICES

Corse disponibili

Available travel

TIPO "A"

(traslante) (sliding)

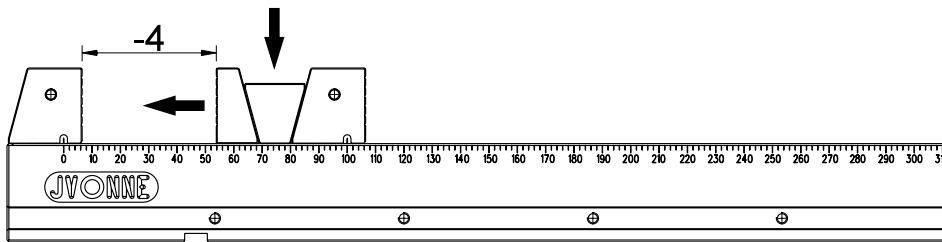
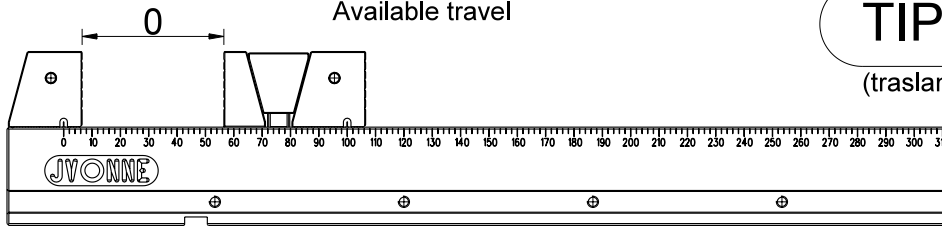

TIPO "B"

(discendente) (descending)

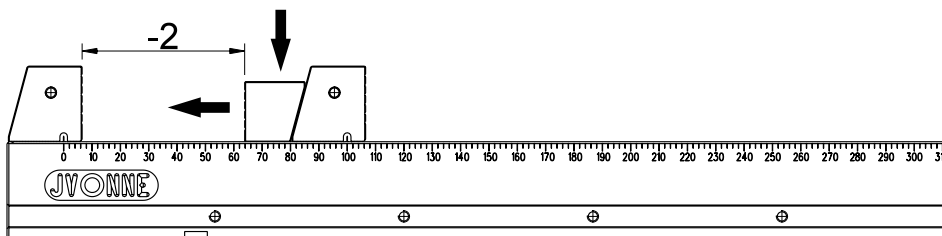
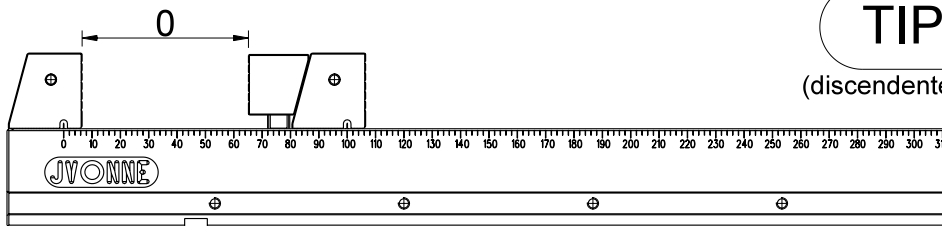

TIPO "C"

(2x1)
(traslante) (sliding)

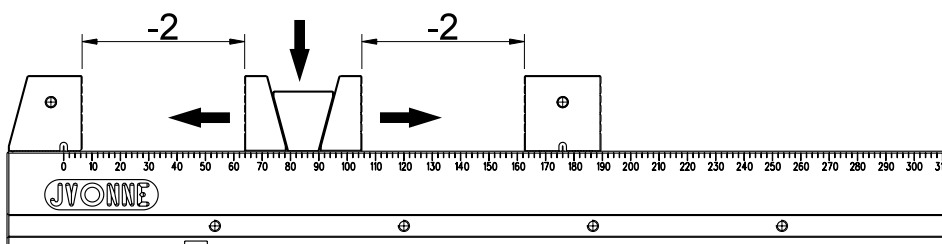
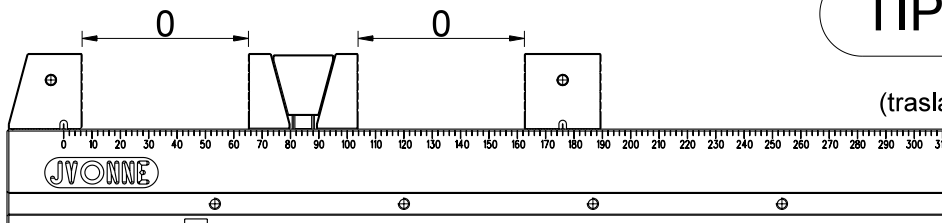

MORSE MULTIPRESA JVONNE

MULTI-GRIP VICE JVONNE

MORSE MULTIPRESA
MULTI-GRIP VICES

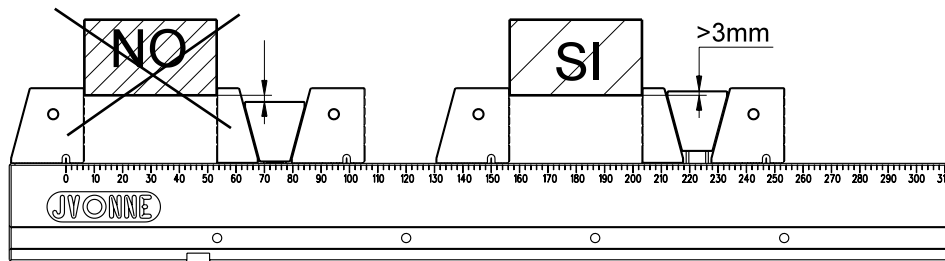
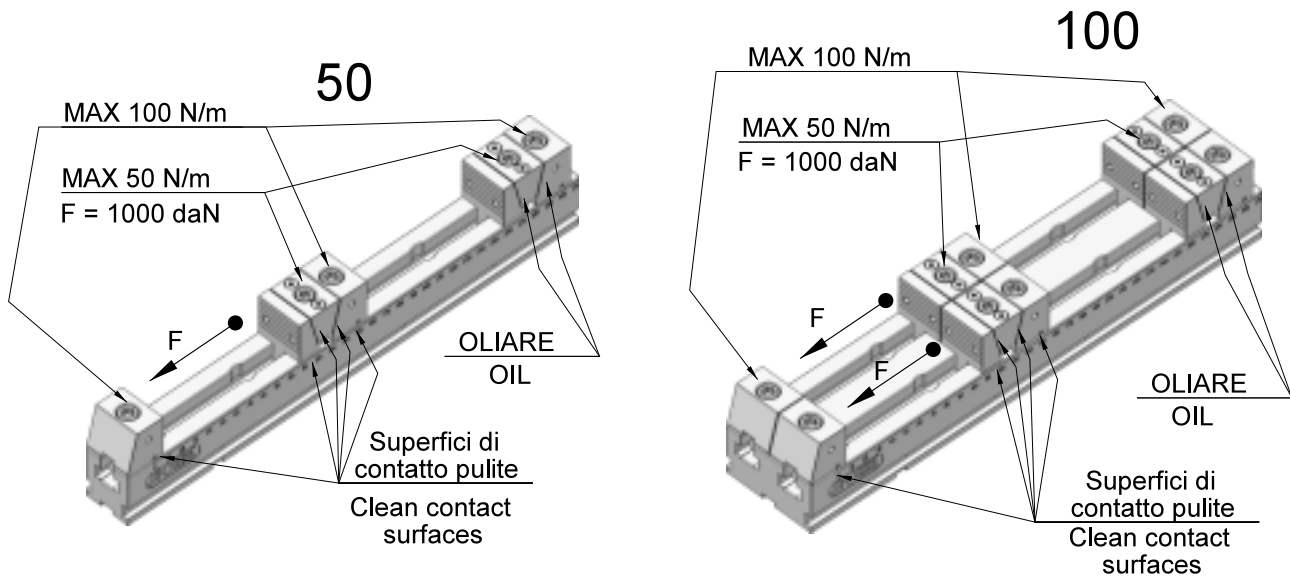

Prescrizioni valide per tutti i tipi di presa pezzo (A,B,C,D,E,F,G,BG, Forte serraggio).

Al fine di ottenere un corretto utilizzo per il serraggio dei pezzi si raccomandano le seguenti modalità:

- pulire con cura le parti zigrinate con soffiaggio di aria compressa;
- assicurare una buona pulizia delle superfici inclinate con una sottile velatura d'olio a bassa densità (diminuisce la perdita di forza dovuta ad attrito);
- chiudere le viti della ganascia fissa con max coppia come indicato;
- chiudere la vite del cuneo di serraggio con max coppia come indicato.

Instructions for all types of piece grips (A,B,C,D,E,F,G,BG, Intense tightening).

Follow the instructions below to ensure the correct tightening of the workpieces:

- carefully clean all knurled parts with compressed air;
- make sure that the sloping surfaces are clean with a thin layer of low density oil (reduces the loss of force due to friction);
- secure the screw of the fixed jaw with a maximum torque as indicated;
- secure the screw of the tightening wedge with a maximum torque as indicated.

MORSE MULTIPRESA JVONNE

MULTI-GRIP VICE JVONNE

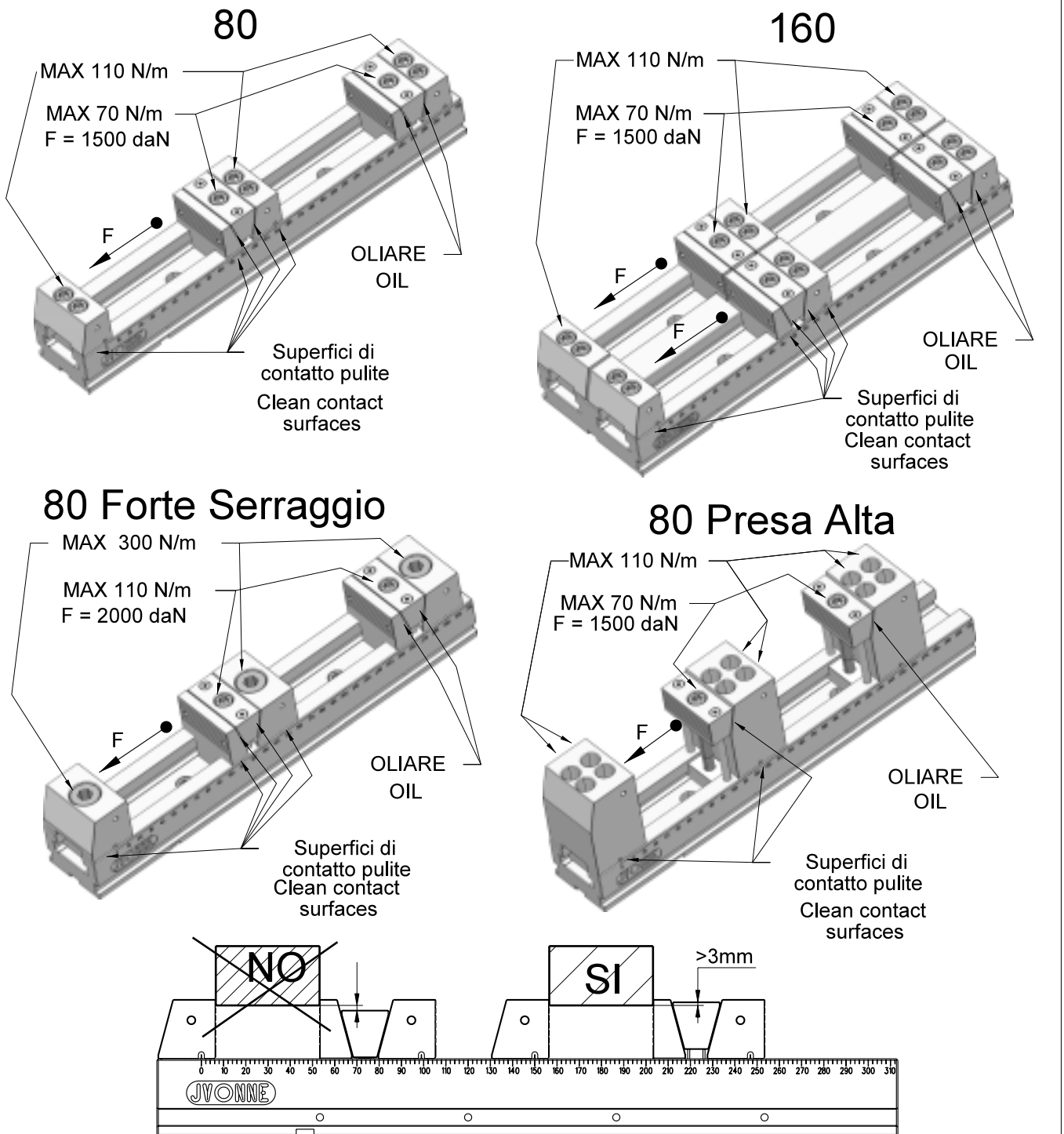

Prescrizioni valide per tutti i tipi di presa pezzo (A,B,C,D,E,F,G,BG, Forte serraggio).

Al fine di ottenere un corretto utilizzo per il serraggio dei pezzi si raccomandano le seguenti modalità:

- pulire con cura le parti zigrinate con soffiaggio di aria compressa;
- assicurare una buona pulizia delle superfici inclinate con una sottile velatura d'olio a bassa densità (diminuisce la perdita di forza dovuta ad attrito).
- chiudere le viti della ganaschia fissa con max coppia come indicato;
- chiudere la vite del cuneo di serraggio con max coppia come indicato.

Instructions for all types of piece grips (A,B,C,D,E,F,G,BG, Intense tightening).

Follow the instructions below to ensure the correct tightening of the workpieces:

- carefully clean all knurled parts with compressed air;
- make sure that the sloping surfaces are clean with a thin layer of low density oil (reduces the loss of force due to friction)
- secure the screw of the fixed jaw with a maximum torque as indicated;
- secure the screw of the tightening wedge with a maximum torque as indicated.

MORSE MULTIPRESA

MULTI-GRIP VICES

Esempi di presa pezzo

Workpiece grip example

Tipo A

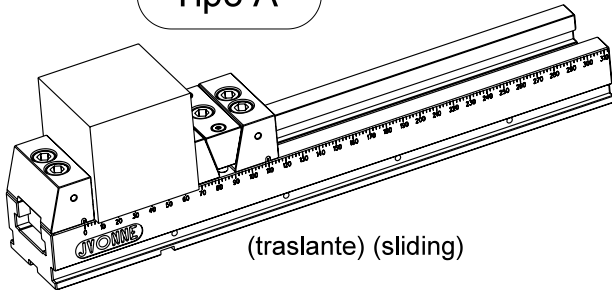

(traslante) (sliding)

Tipo B

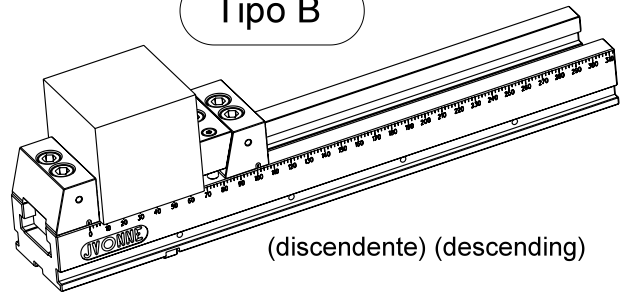

(discendente) (descending)

Tipo C

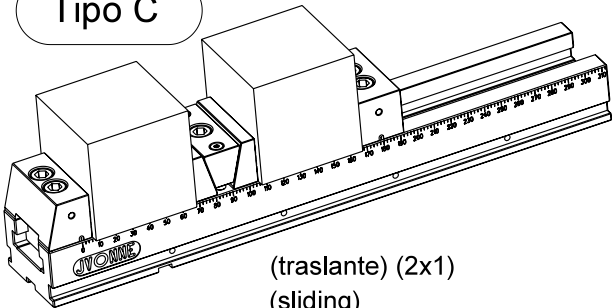

(traslante) (2x1)
(sliding)

Tipo D

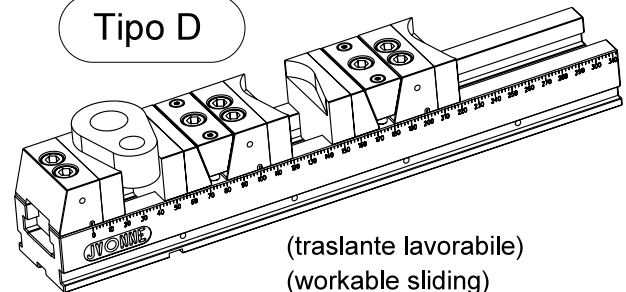

(traslante lavorabile)
(workable sliding)

Tipo E

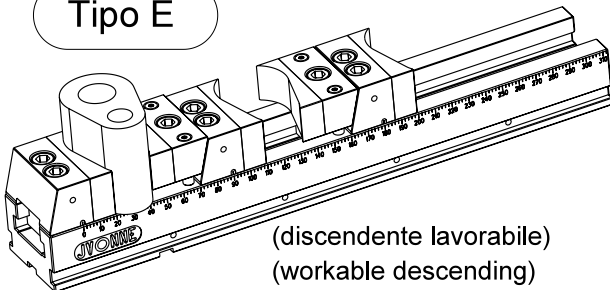

(discendente lavorabile)
(workable descending)

Tipo F

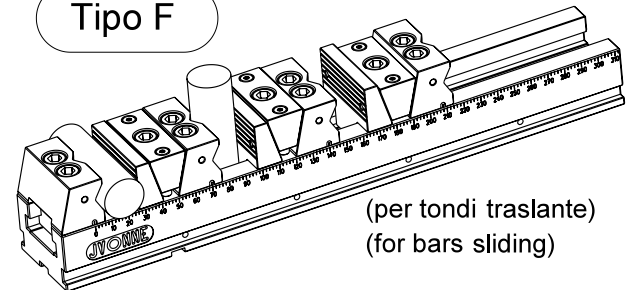

(per tondi traslante)
(for bars sliding)

Tipo BG

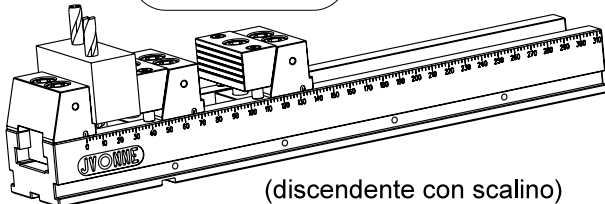

(discendente con scalino)
(descending with step)

Tipo G

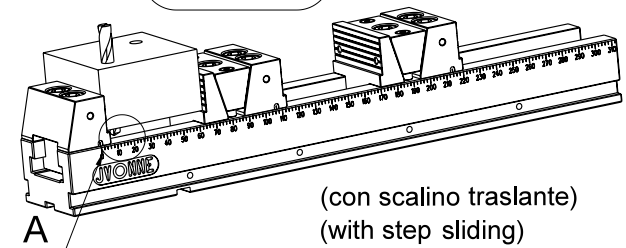

(con scalino traslante)
(with step sliding)

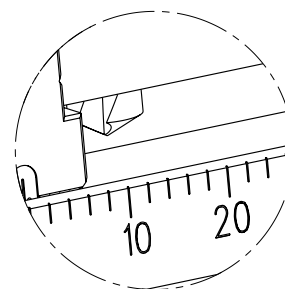
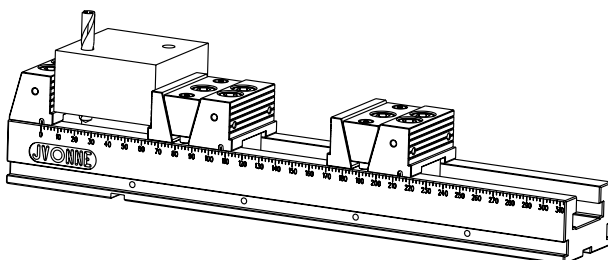

Dettaglio A
Scala: 1:1

MORSE MULTIPRESA

MULTI-GRIP VICES

Esempi di presa pezzo

Workpiece grip example

Tipo AW

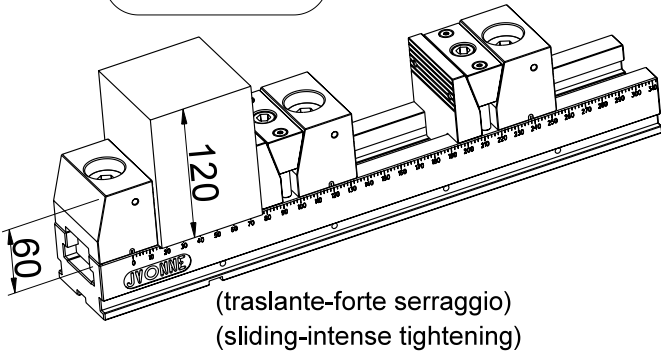

Tipo BX

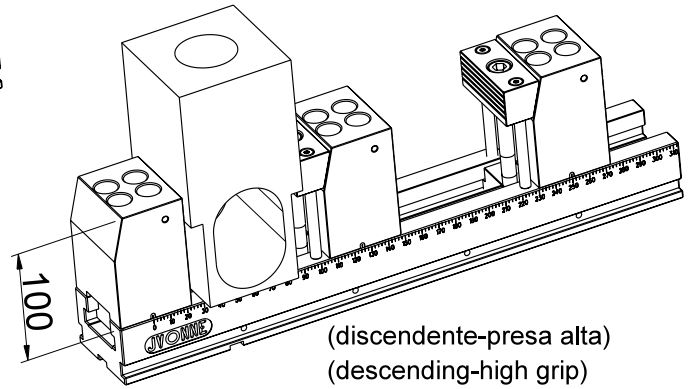

Tipo BW

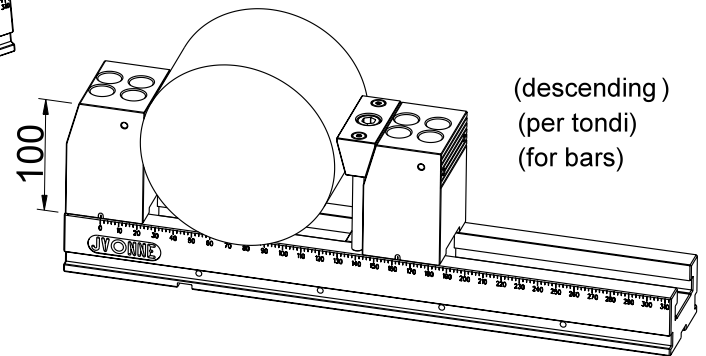
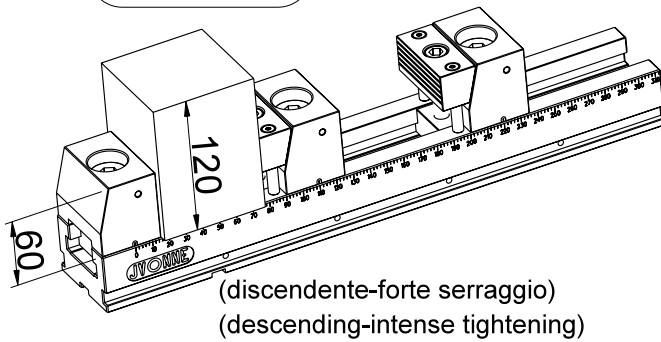

Tipo CW

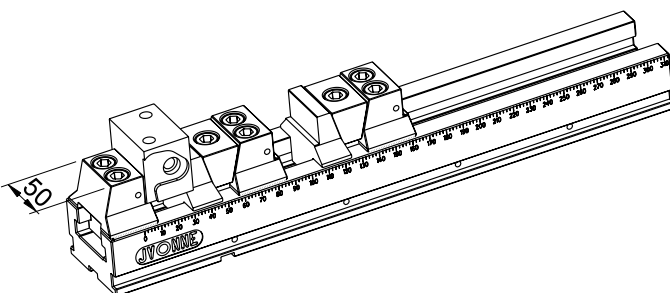
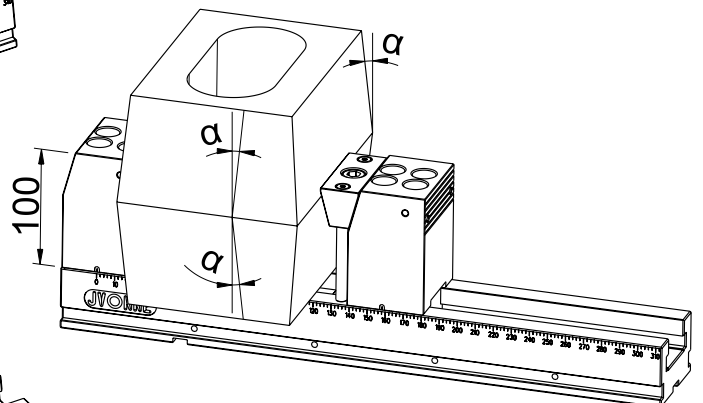
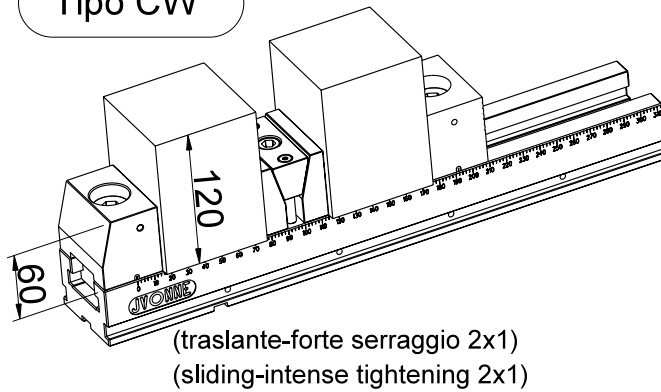

MORSE MULTIPRESA

MULTI-GRIP VICES

Confronto con concorrenza

Comparison with competitors

Confronto a parità di lunghezza morsa e a parità di lunghezza di pezzi

Comparison with equal vice length and equal length of workpieces

ALTRO COSTRUTTORE
OTHER MANUFACTURER

Concorrenza
Morsa L700
Monopresa
1 pezzo
L 70mm
Competitor
Vice L700
Single-grip
1 workpiece
L 70 mm

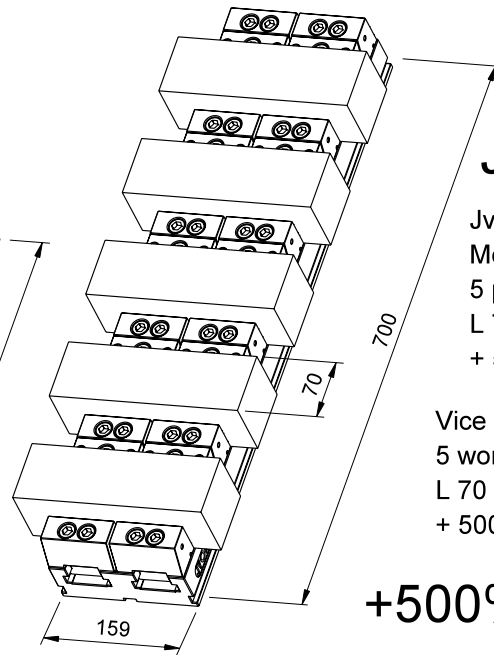
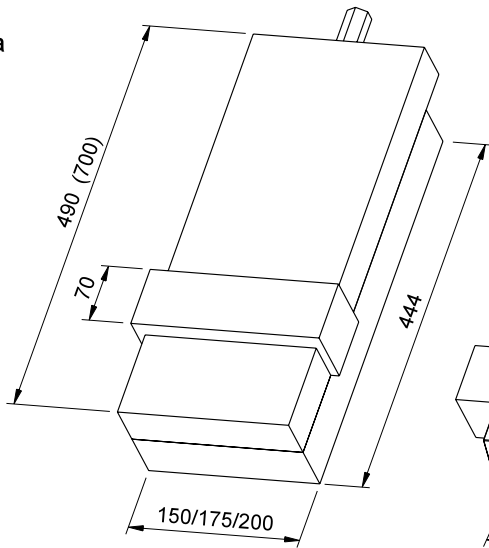

JVONNE

Jvonne
Morsa L700
5 pezzi
L 70
+ 500% di pezzi

Vice L700
5 workpieces
L 70
+ 500% of workpieces

+500%

Confronto a parità di lunghezza pezzo

Comparison with equal length workpiece

ALTRO COSTRUTTORE
OTHER MANUFACTURER

Concorrenza
Morsa L700
Monopresa
1 pezzo
L 200mm
(max apertura)
Competitor
Vice L700
Single-grip
1 workpiece
L 200 mm
(max opening)

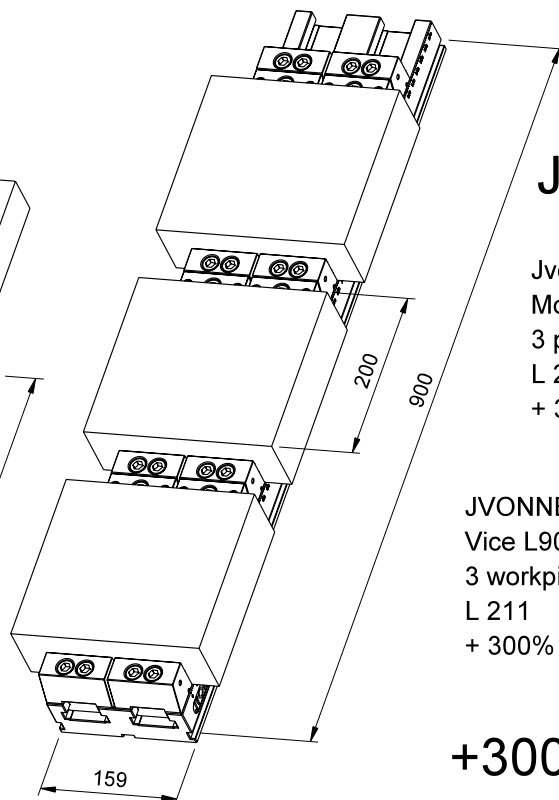
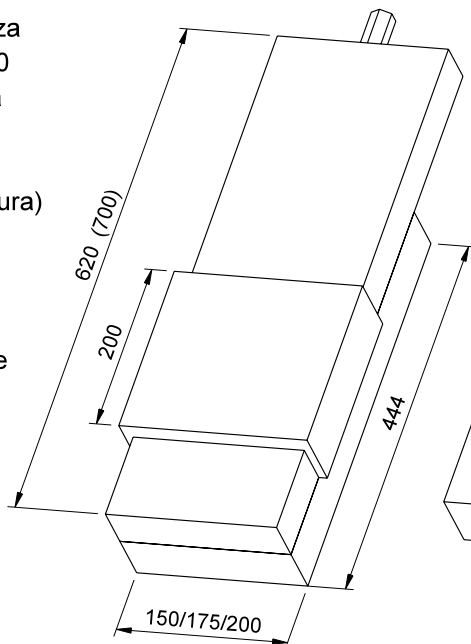

JVONNE

Jvonne
Morsa L900
3 pezzi
L 211
+ 300% di pezzi

JVONNE
Vice L900
3 workpieces
L 211
+ 300% of workpieces

+300%

MORSE MULTIPRESA
MULTI-GRIP VICES

Confronto con concorrenza

Comparison with competitors

Confronto a parità di lunghezza morsa e a parità di n° di pezzi

Comparison with vices of equal length and equal number of workpieces

**ALTRO
COSTRUTTORE**
OTHER MANUFACTURER

Concorrenza
Morsa L700
7 pezzi
L 17mm

Competitor
Vice L700
7 workpieces
L 17mm

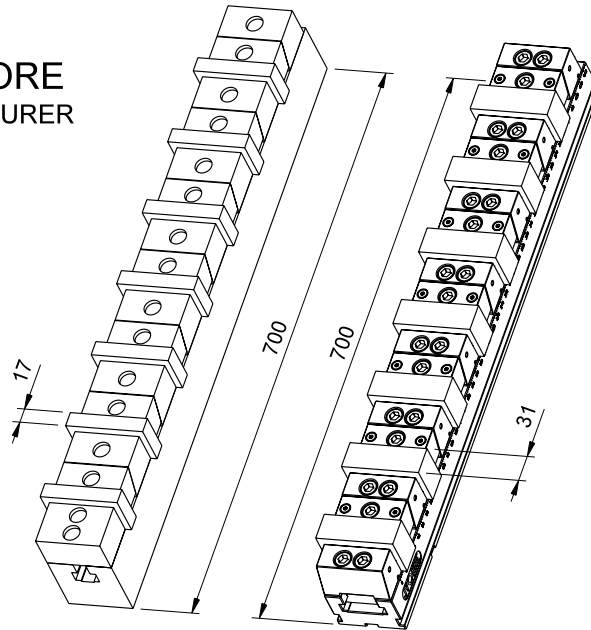

JVONNE

Jvonne
Morsa L700
7 pezzi
L 31
+ 82% di spessore

JVONNE
Vice L700
7 workpieces
L 31
+ 82% of thickness

+82%

Confronto a parità di lunghezza pezzo

Comparison with equal length workpiece

**ALTRO
COSTRUTTORE**
OTHER MANUFACTURER

Concorrenza
Morsa L700
2 pezzi
L 150mm

Competitor
Vice L700
2 workpieces
L 150 mm

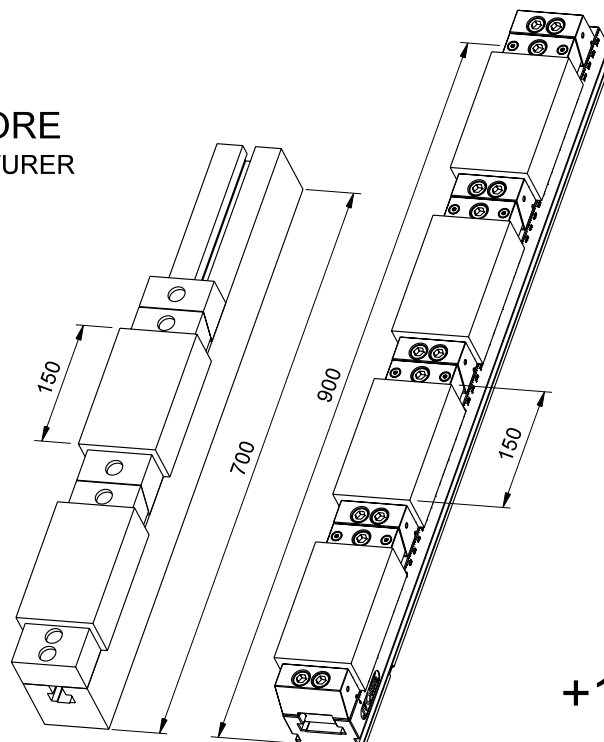

JVONNE

Jvonne
Morsa L900
4 pezzi
L 152
+ 100% di pezzi

JVONNE
Vice L900
4 workpieces
L 152
+ 100% of workpieces

+100%

MORSE MULTIPRESA

MULTI-GRIP VICES

MORSE MULTIPRESA
MULTI-GRIP VICES

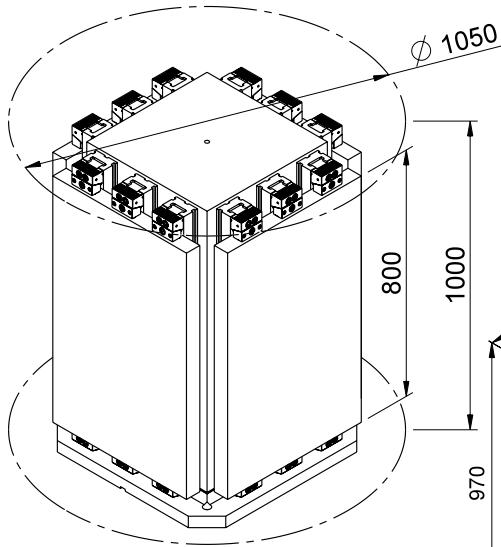

La nuova linea di Morse Multipresa JVONNE permette di CREARE Cubi Multipresa con **MISURE MAI VISTE PRIMA.**

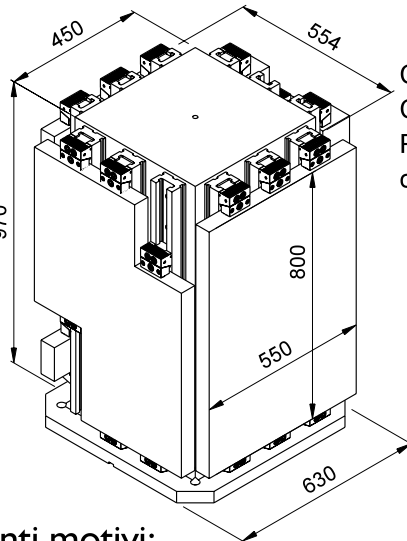

Cod. : J 02 633 S 80 B
Cubo Quadro Multipresa
Pallet 630x630 H970
completo di 12 morse J 80 900 B

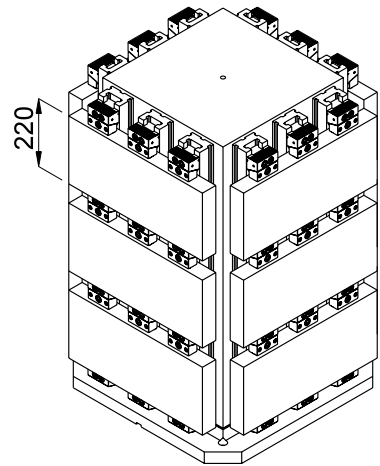

Misure eccezionali per i seguenti motivi:

- 1 - gruppo di spinta molto compatto e rigido
 - 2 - lunghezza morsa fino a 900mm per presa pezzo fino a 800 mm
- PESO CUBO CONTENUTO**

Ecco esplicitati alcuni esempi

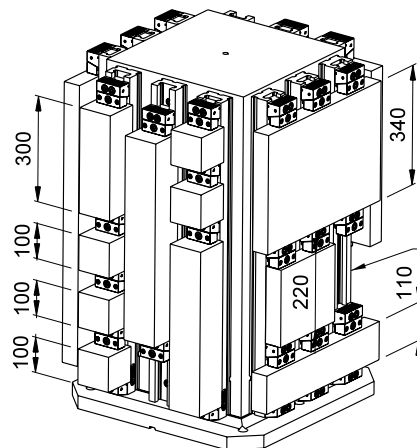
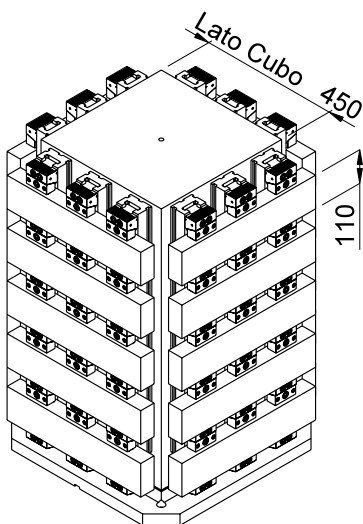

Morsa J 80 900 B
L = 900

MORSE MULTIPRESA

MULTI-GRIP VICES

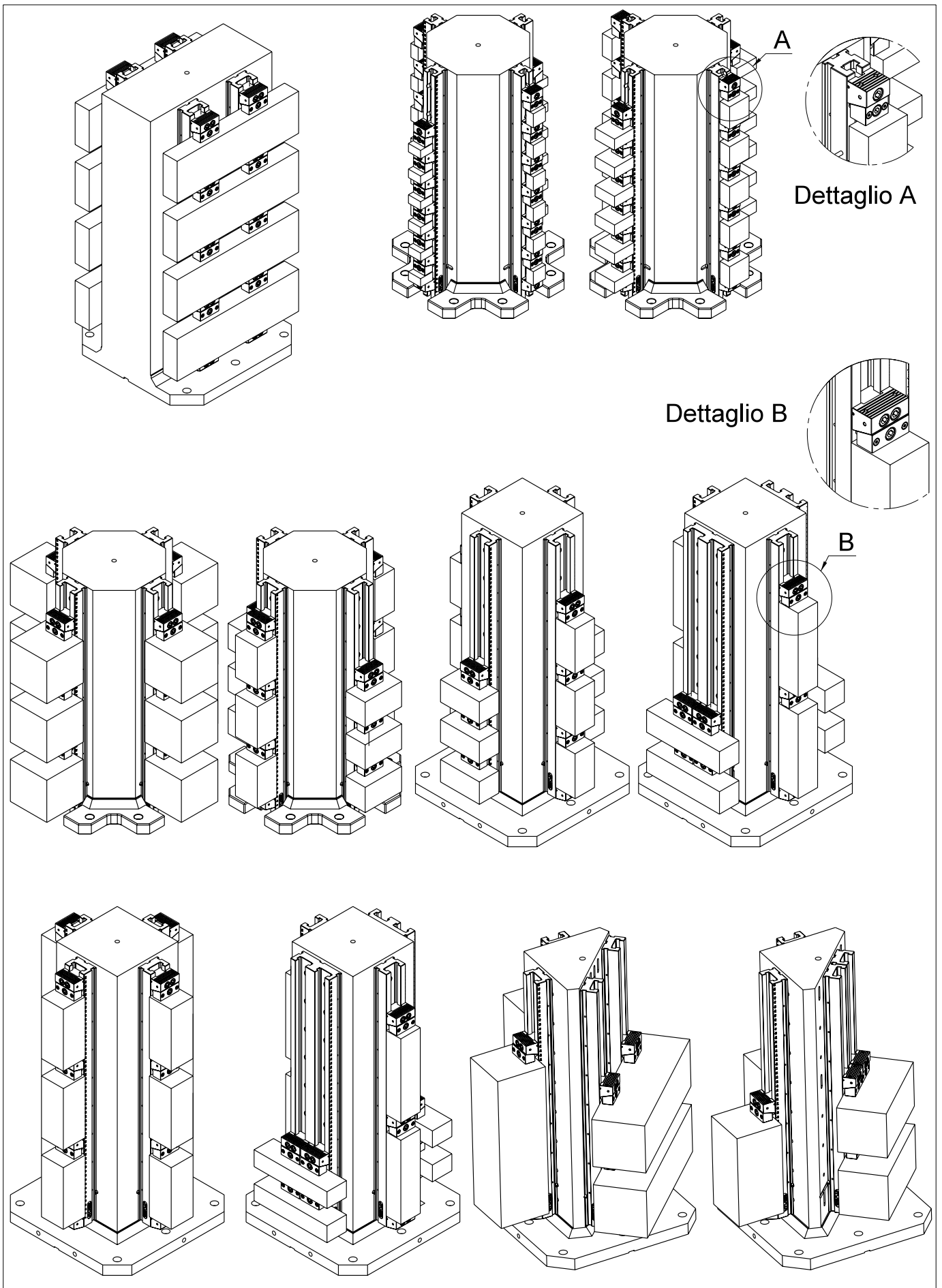

MORSE MULTIPRESA
MULTI-GRIP VICES