



Super Rigid Modular Chuck

Mandrini avvitabili

- HIGHER CUTTING CONDITIONS
- LESS VIBRATION
- LESS DEFLECTION



**Increase productivity
with high efficiency
processing**

Feature - High Rigidity

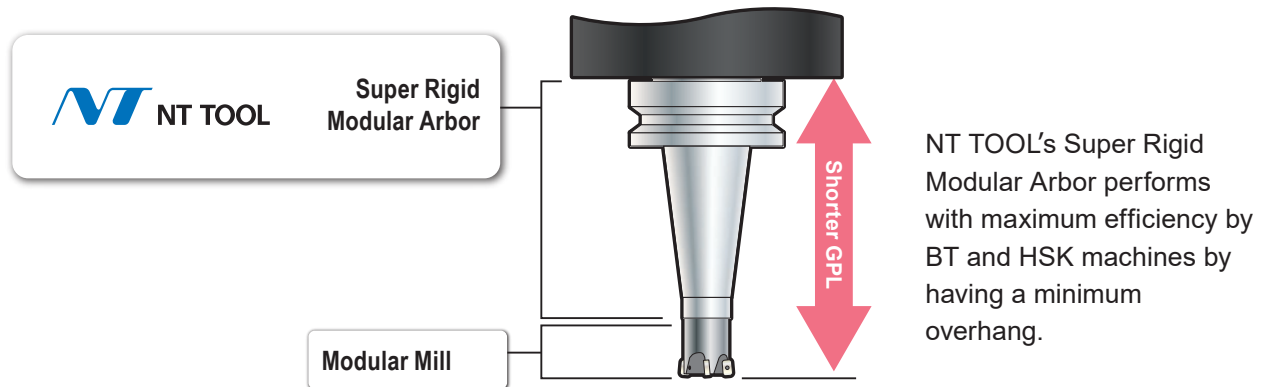

Enable to reduce cycle time for roughing process of mold

Field data Material : S50C Cutter : Dia 25 (MOLDINO TD4N)

Cutting condition

$V_c = 179\text{m}$
 $F = 15,401\text{mm/min}$

$F_z = 1.68\text{mm/t}$
 $A_p = 0.8\text{mm}$

$A_e = 17.5\text{mm}$

Milling Chuck + Long Indexable Tool

- ✗ Vibration
- ✗ Deflection
- ✗ Lower Cutting Conditions

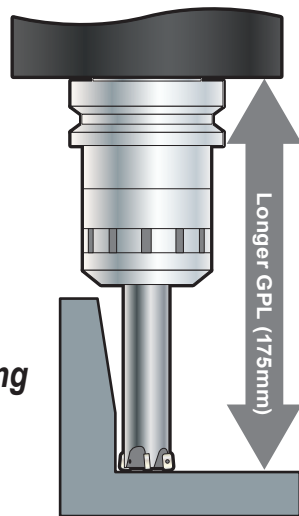

Chattered and uneven

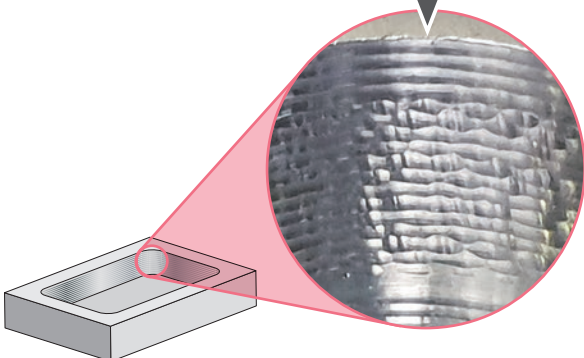

Super Rigid Modular Arbor + Modular Mill

Avoid interference and make total tool length shorter

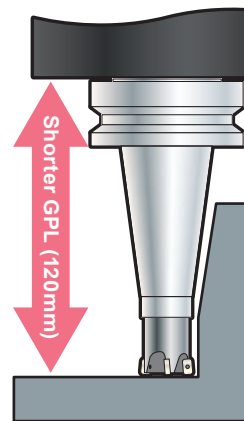

- ✓ Less Vibration
- ✓ Less Deflection
- ✓ Higher Cutting Conditions

Smooth Cutting

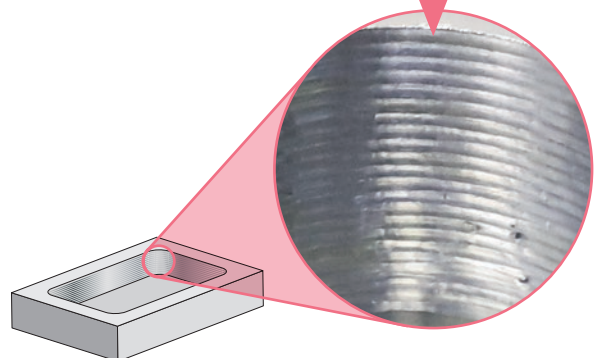

HSK63A

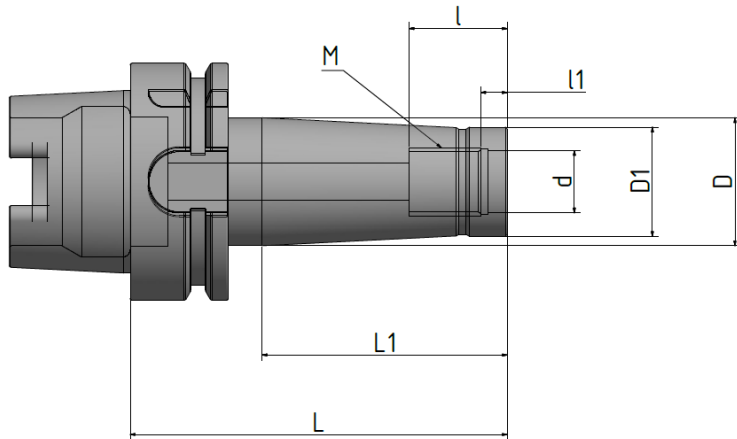

Order Example

HSK63A - M16 - 100T - IDN

Shank Size

M

A

Model	M	A	UL	d1(H7)	D2	D3	L2		
HSK63A - M 8 - 100T - IDN	8	100	65	8.5	13	23	20		
HSK63A - M10 - 100T - IDN	10	100	65	10.5	18	28	22		
HSK63A - M12 - 100T - IDN	12	100	65	12.5	21	31	25		
HSK63A - M16 - 100T - IDN	16	100	65	16.5	29	34	26		

coolant unit included in delivery

Select arbor that matches screw size of cutter.

Do not apply lubricants to the threaded section or end surface sections in contact with the dedicated shank/arbor for modular mills.

SK40

BT40

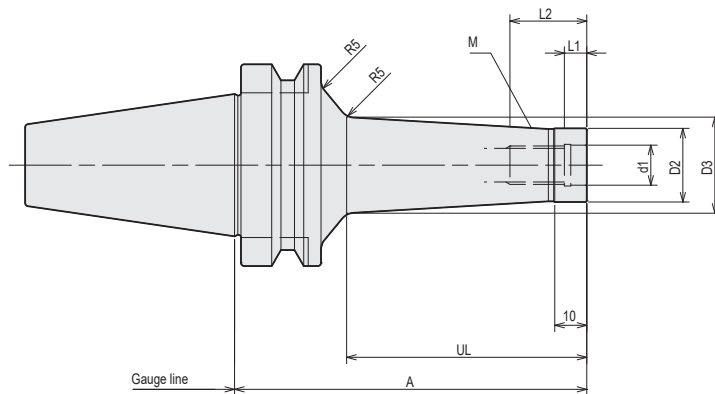

not yet available

Order Example

BT40 - M12 - 100T

Shank Size

M

A

Model	M	A	UL	d1(H7)	D2	D3	L1	L2	
SK40-M8-100T	8	100	80.9	8.5	13	23	7	20	
SK40-M10-100T	10	100	80.9	10.5	18	28	7	22	
SK40-M12-100T	12	100	80.9	12.5	21	31	7	25	
SK40-M16-100T	16	100	80.9	16.5	29	34	7.5	26	

Select arbor that matches screw size of cutter.

Do not apply lubricants to the threaded section or end surface sections in contact with the dedicated shank/arbor for modular mills.